

# Line-Mounting Body, Size 12

Type: 12 Series - 4-Way - Flow divider

## 1 Technical data

Ordering code	Description	Material	Maximum operating pressure	Weight	Port 2	Port 3	Port 4
06BA	30355	Aluminium	3000 psi [210 bar]	2.160 lbs [0.98 kg]	G 1/2" -14 BSP	G 3/4" -14 BSP	G 1/2" -14 BSP
06BS	30361	Steel	5000 psi [350 bar]	6.285 lbs [2.85 kg]	G 1/2" -14 BSP	G 3/4" -14 BSP	G 1/2" -14 BSP
12TA	30357	Aluminium	3000 psi [210 bar]	2.130 lbs [0.97 kg]	SAE-10	SAE-12	SAE-10
12TS	30363	Steel	5000 psi [350 bar]	6.204 lbs [2.81 kg]	SAE-10	SAE-12	SAE-10

## 2 Dimensions & sectional view

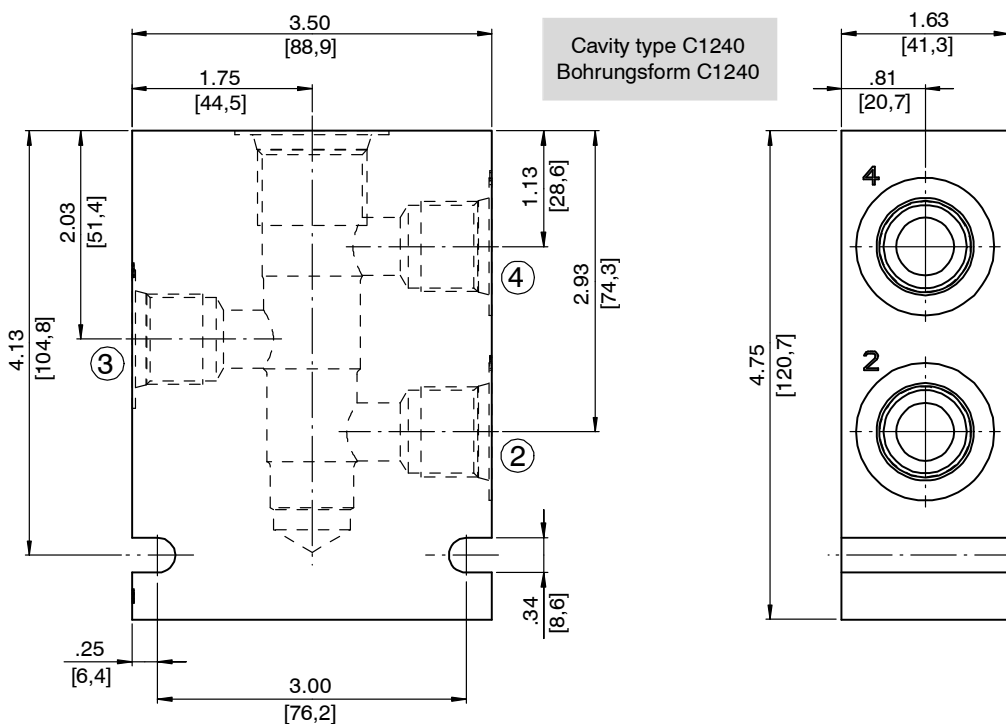

## 3 Related data sheets

Reference	(Old no.)	Description
520-P-000430	(0-043.0)	Cavity type C1240

[info.el@bucherhydraulics.com](mailto:info.el@bucherhydraulics.com)

[www.bucherhydraulics.com/commoncavity](http://www.bucherhydraulics.com/commoncavity)

© 2015 by Bucher Hydraulics, Inc., 2545 Northwest Parkway, Elgin, Illinois 60124, USA

All rights reserved.

Data is provided for the purpose of product description only, and must not be construed as warranted characteristics in the legal sense. The information does not relieve users from the duty of conducting their own evaluations and tests. Because the products are subject to continual improvement, we reserve the right to amend the product specifications contained in this catalogue.

Classification: 430.395.-.-.

Reference: 520-P-000432-EN-01